

It's not what you see . . .



**Grip-Tite**<sup>TM</sup>  
CABLE SUPPORT SYSTEMS

**Industrial Sales Corporation**

# ...it's what you don't see.

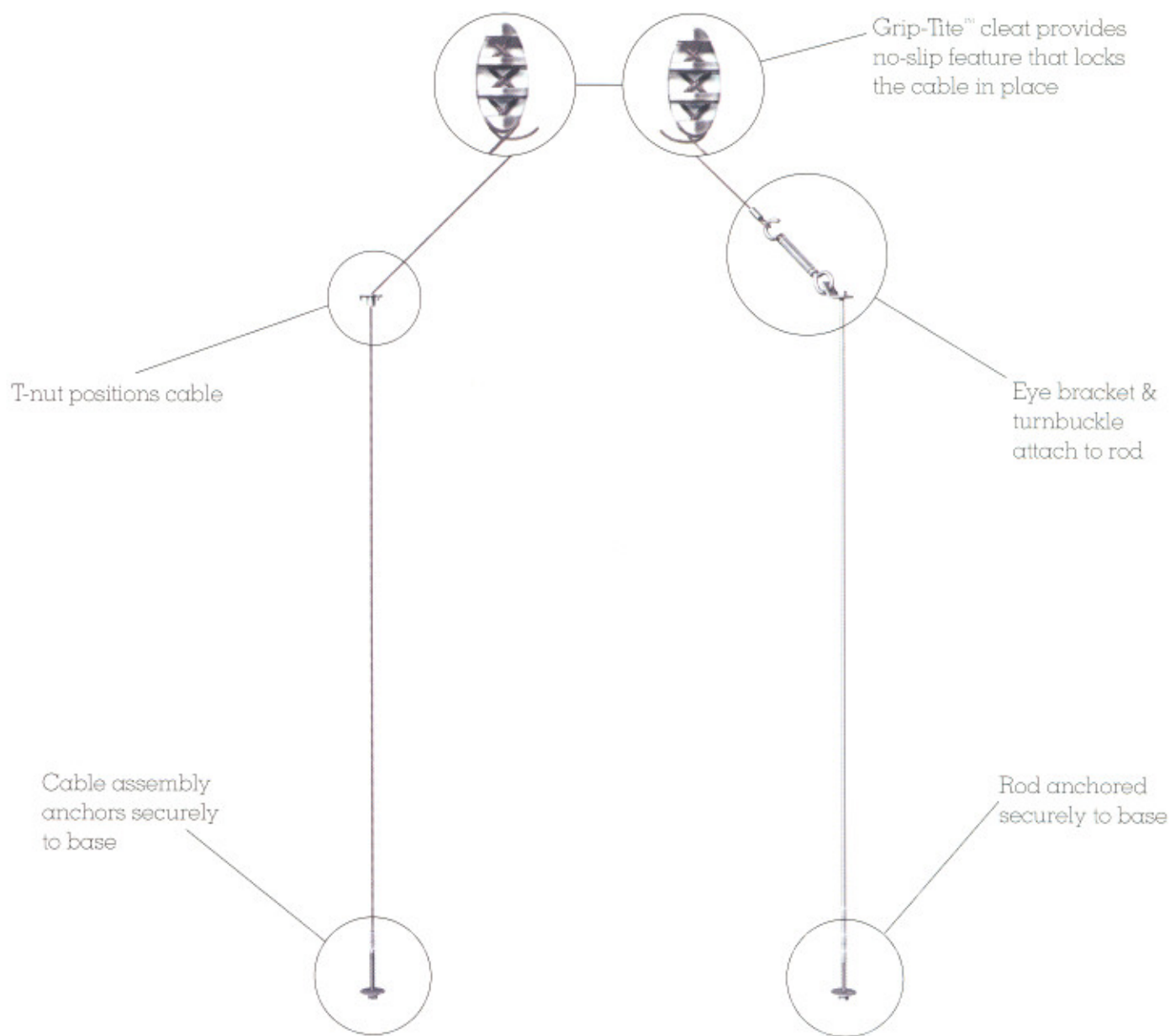

**Grip-Tite™**  
CABLE SUPPORT SYSTEMS

## Quality Products for the Window and Door Industry

Since 1979 Industrial Sales Corporation has been supplying a complete offering of window and insulating glass components to the window and door industry. ISC has developed into one of the industry leaders known for the quality products and excellent service that it provides to the manufacturer. This commitment to excellence

continues with the Grip-Tite™ cable support system that offers adjustable support for bay and bow windows. This time tested system distributes the window load to the solid structure portion of the building while at the same time helping the installer to level the window during the installation process.

## Cable Support Systems Designed for the Projection Window Market

Industrial Sales Corporation offers a variety of cable support kits designed to fit any projection window manufacturer's needs. There are two designs; one a cable version and the other a rod version. For the cable version the cable runs through the mullion and is secured at the seat board. When a threaded rod is inserted in the mullion, our rod version is used and is secured at the top of the rod with a specially designed bracket and coupler. Both are illustrated here.

Another nice feature of the Grip-Tite™ cable support system is how our design allows for easy accessibility should adjustments need to be made at either the head or seat board area.

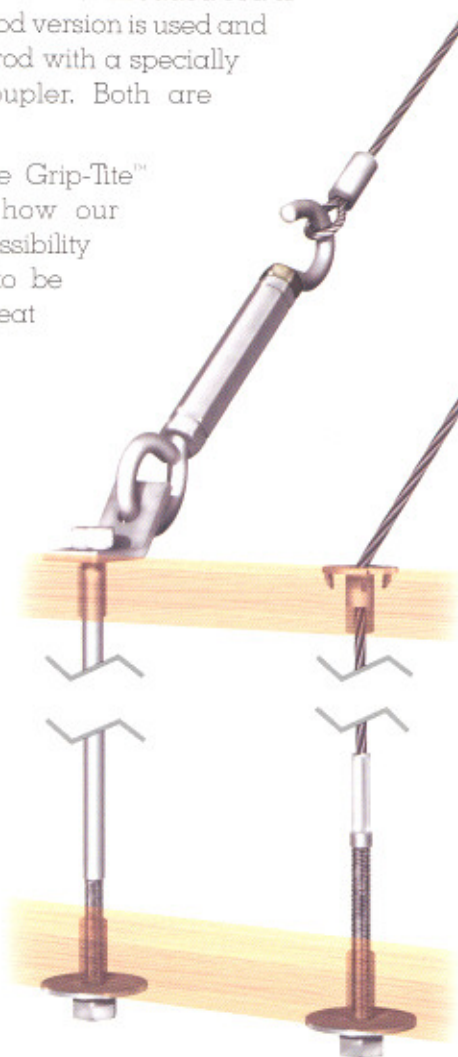
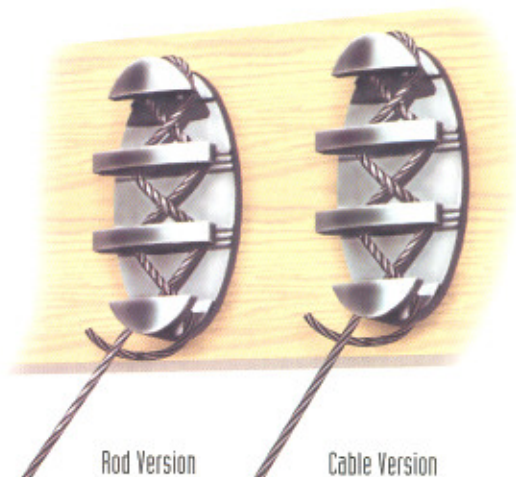

- Unique cleat design locks cable in place.
- Will not slip.
- Eliminates potential sagging problems.
- Greatly reduces need for field service calls.
- Simple & easy to install.
- Comes standard with many window manufacturers' bay & bow windows.
- Use of kit built into manufacturer's warranty.

**Grip-Tite™**



### The Most Reliable and Trustworthy Cable Support System Designed for Bay/Bow Windows

The Grip-Tite™ cable support system provides a simple, very effective way to install projection windows. Through the use of its cleat design, not only are potential sagging problems eliminated but the windows are easier to correctly install. The cleat is like having a partner working with you that enables the installer to easily set and level the window in place. One of the most important features is how popular the kit becomes with installers and

contractors once they experience how easy it is to use. Of course, for the window manufacturer there are other great benefits like reduced field costs and better warranty protection.

All of this adds up to greater satisfaction amongst installers and contractors in handling your windows, along with providing better product performance which increases sales and results in higher profits for you the window manufacturer!

## Complete Product Offerings

While there are two basic designs for Grip-Tite™ cable support kits there are 5 kits available as standard items to fit most every window manufacturer's needs. The two main kits are model 1000 (cable version) and model 2000 (rod version) and whether or not a rod is inserted in the mullion determines which one to use. Both feature a 9 foot cable length which works best in most situations and the model 2000 rod version is designed for use with a 5/16" threaded rod.

In addition to these models, ISC also offers a 14 foot cable version (model 1400) when greater cable length is needed; a rod version designed for 3/8" threaded rods (model 2300) when that size rod is used; and a special version of the cable system (model 1700) where a special plate is used to attach to the header and seat board due to the window design having a gap at the mullion area. This product offering is the most complete in the industry and **ISC always maintains these items in stock.** For unique window designs we have the staff and knowledge to develop a custom kit for those window manufacturers who have this special need.

## High Quality Standards and Components

At Industrial Sales Corporation quality products are a must. All of our cable support kits use 1/8 inch galvanized steel aircraft cable which is a proven time tested standard for support cable. All of our cable assemblies have a minimum break strength of 1700 pounds and are tested to meet AQL standards for this level of strength. We use high quality products and tough performance standards so that each and every window manufacturer is assured that they are using the best cable support system on the market. ISC has a proven commitment to quality and exceptional service that continues with its Grip-Tite™ cable support systems.



**#1000 Cable Kit** includes: 2 - 9' support cables, 2 - washers, 4 - 2 1/2" wood screws, 2 - T nuts, 4 - 1/4" hex nuts, & 2 - Grip-Tite™ cleats.

**#1400 Cable Kit** is the same with 14' support cables.



**#2000 Rod Kit** includes: 2 - support cables w/ turn-buckles, 4 - 2 1/2" wood screws, 2 - eye brackets, 2 - 5/16" hex nuts & lock washers, & 2 - Grip-Tite™ cleats.

**#2300 Rod Kit** is the same with 3/8" hex nuts & lock washers.

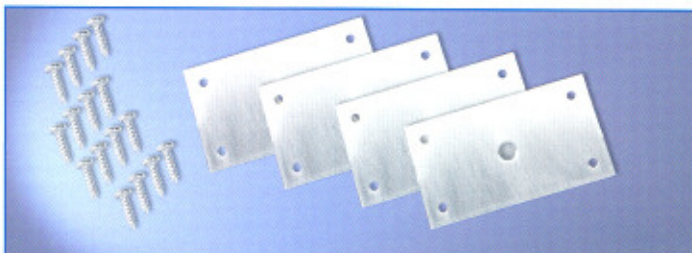

**#1700 Plate Kit** has 4 - heavy duty plates and fasteners added to the #1000 Cable Kit.



**Industrial Sales Corporation**  
727 Post Road East • Westport, CT 06880  
ph: 203-227-5988  
fax: 203-227-2263  
email: [custserv@iscamerica.com](mailto:custserv@iscamerica.com)

## Grip-Tite™ Deluxe Model 2000 Cable Support Kit

**Line Art - Intended for use by window manufacturer only, in developing its own specific instructions for installing its brand of projection windows.**

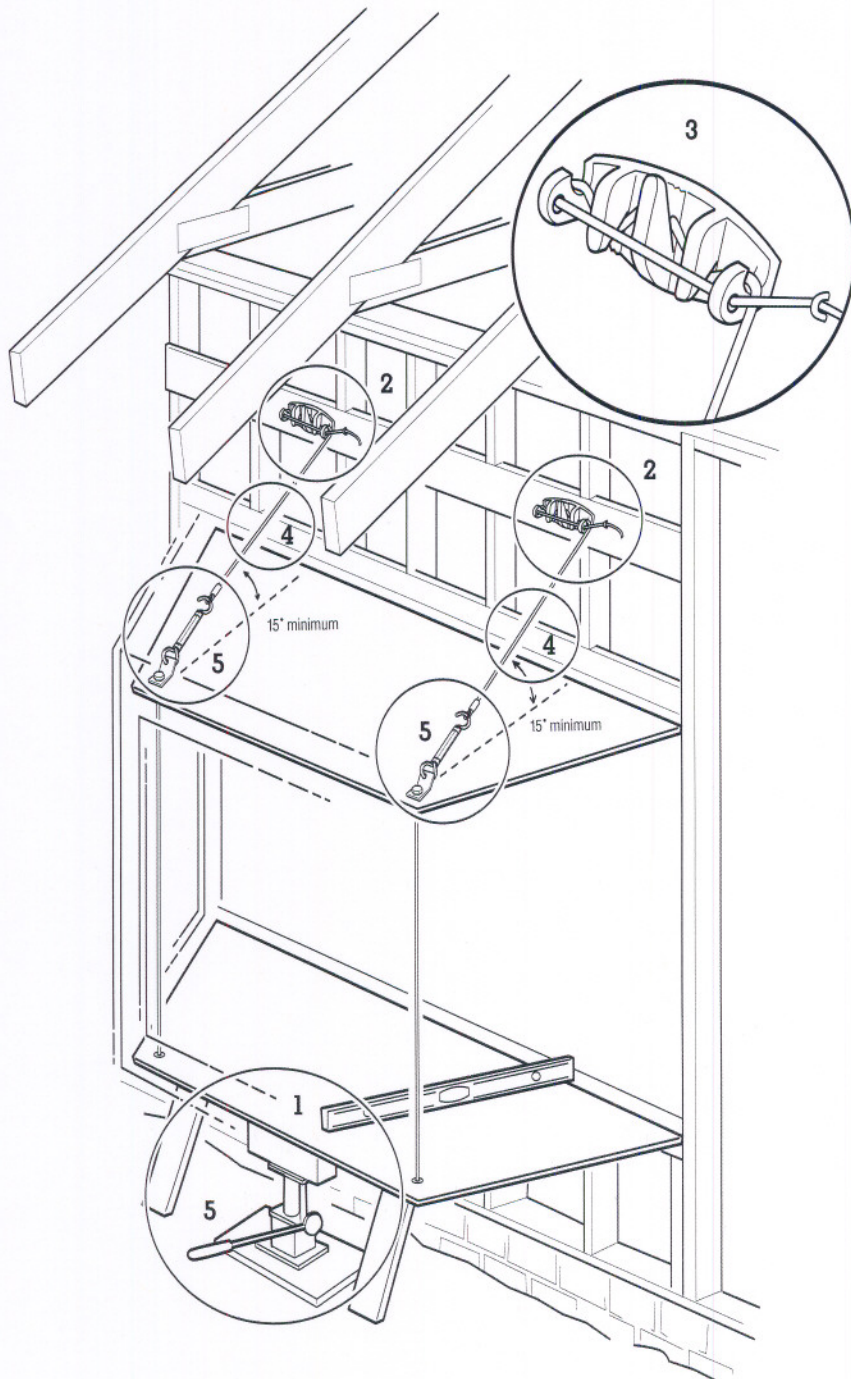

**Always refer  
to the manufacturer's  
installation guide!**

- 1.) Initial installation of unit using jack and temporary support braces along with level, unit should be slightly raised above level position.
- 2.) Mount Grip-Tite™ cleats in appropriate position as shown with outside fingers pointing upwards.
- 3.) Wrap cable through first end finger of Grip-Tite™ cleat pulling cable tight; then weave cable through remaining fingers of cleat and thread excess cable through holes on top of Grip-Tite™ cleat and secure any excess cable over 12 inches with fence staple at any convenient location.
- 4.) Carefully place load on cable system to seat cables.
- 5.) **WARNING!** - For upward adjustment never lift unit by tightening cable hex nut - always use jack and temporary braces to lift unit before adjusting coupler.

**WARNING!**  
Always use proper tools and caution when installing window unit.

**Disclaimer** - ISC assumes no responsibility for providing installation instructions for any window manufacturer's projection windows. The above is Line Art only and is intended solely to aid each window manufacturer in developing window installation instructions specific to its own brand of projection windows. ISC assumes no liability for personal injury, property damage or repair costs for improper installation of any projection window or for providing this Line Art.

# New Grip-Tite® Deluxe Model 4000 Cable Support System

Each kit includes our new patented Grip-Tite® cleat that features the original easy lace, permanent locking system along with the new convenient tag end control design.

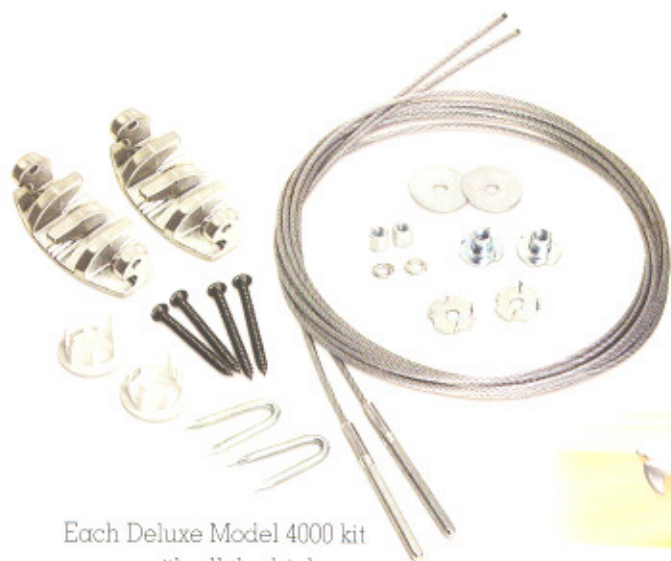

Each Deluxe Model 4000 kit comes with all the high quality hardware needed for great installations including fence staples and hole plugs for recessed or rigid foam applications.

Our new No Twist locking feature on the cable stud end utilizes a specially designed stud and lock washer combination that holds each cable in place and prevents any twisting when tightening the cable and performing final leveling and installation.

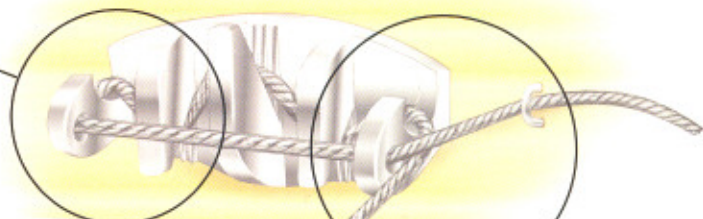

Once cable is laced and locked in place all remaining cable is fed through the top holes of the Grip-Tite® cleat for easy handling, control and neatness. Any excess cable is stapled off using the fence staples provided.

Eliminates any extra tools and handling problems which may occur. Every installation is Twist free and easy to complete.

Every cable is locked in place at the seat board end allowing for easy installation of the nut and final adjustment of the bay and bow window.

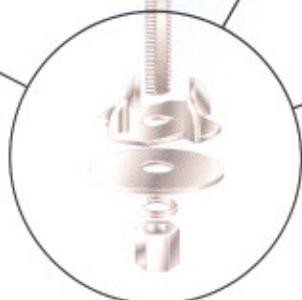

For nearly 2 decades Grip-Tite® style cleats have provided the only time proven kit with over a half million successful installations.

**Industrial Sales Corporation**